

**Key Legend**

- 1 **ROOF TYPE 1:**  
 Waterproof monolithic Hot applied roof with gravel ballast covering to achieve current building regulations part L requirements consisting of:  
 40 mm ballast  
 Geotextile Protection sheet  
 Kingspan Styrozone N300 thickness TBA  
 Water proofing 2 coat system.  
 200mm Concrete PC planks with 75mm screed laid to falls  
 Roof to achieve an overall min 'U' value of 0.17 W/m<sup>2</sup>K
- 2 **ROOF TYPE 2:**  
 Reinforced Single-Ply Membrane adhered to TBA thickness Kingspan Thermaroof TR27 insulation (or similar approved) onto VCL and Perforated Metal Dacking System (to SE specification) to achieve a Min overall 'U'-Value of 0.17W/m<sup>2</sup>K
- 3 **ACCESS HATCH**  
 Bitco or similar approved insulated access hatch.
- 4 **PPC ALUMINIUM FEATURE CAPPING**  
 Architectural coping system. Continuous PPC aluminium capping system to all roof perimeter parapets .
- 5 **FREE STANDING BALUSTRADING SYSTEM**  
 Latchways or similar approved free standing balustrading system.
- 6 **PHOTOVOLTAIC PANELS**  
 Photovoltaic panels to BAM M&E specification
- 7 **ALUMINIUM ROOFLIGHT:**  
 Thermally broken aluminium PPC double glazed rooflight system to be high performance solar control to meet performance, g-factor of 0.3. Actuators required for openable panels
- 8 **ETFE:**  
 Novum or similar approved ETFE roof. TBA

**Please Note**  
 All constructions build ups noted below are subject to design review and 'U' value calculation checks with relevant insulation manufacturer. Suppliers to meet to relevant BS standards and provide BBA certificates and provide evidence of green guide ratings to meet BREEM requirements.

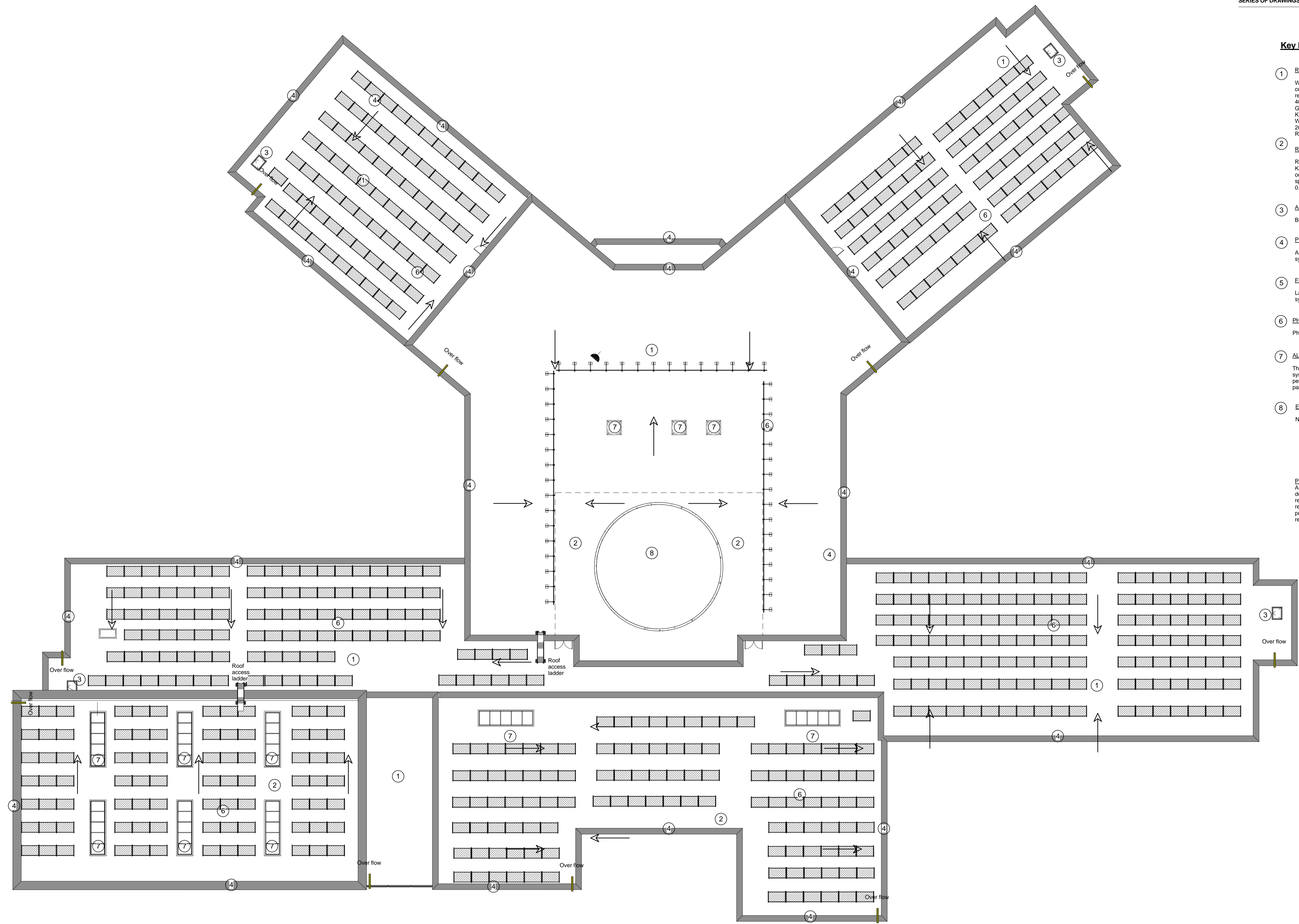

**Status Code (as defined in BS1192)**  
 D3 - Issued for contractor design  
 D4 - Issued for manufacture/procurement

**Work In Progress (WIP)**  
 S0 - Initial Status or WIP

**Shared**  
 S1 - Issued for co-ordination  
 S2 - Issued for information  
 S3 - Issued for internal review  
 S4 - Issued for construction approval

**Documentation (Pre-construction)**  
 D1 - Issued for costing  
 D2 - Issued for tender

**Documentation (Contractual)**  
 A - Issued for construction  
 B - Issued for construction but with comments  
 C - Comprehensive revision required

**Archive**  
 AB - Record Drawing

rev	by	chkd	date	description
B	DCW	JD	27/07/15	Drawings updated to indicate rationalisation of wings to achieve symmetry; post ITT changes to layouts and resetting of doors and windows to suit
A	AJR	JR	02/06/2015	Roof types, RW0 positions and overflows indicated

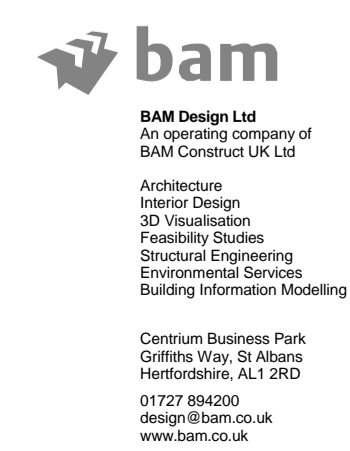
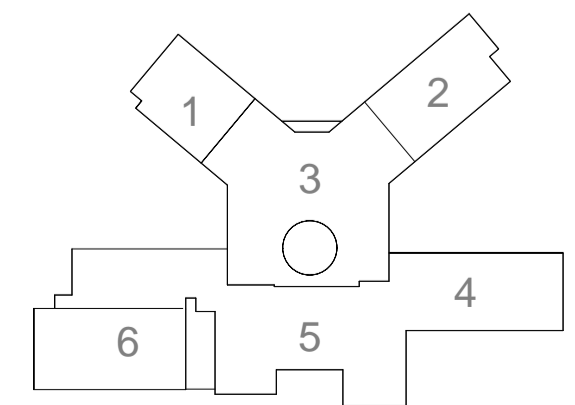

project Nishkam West London

title **General Arrangement - Roof Plan**

scale 1 : 200 @ A1

date 04/01/15

project code NHWL- BMD- MB-XX- DR- A

drawn JW

checked JR

design @ bam.co.uk

BAM job no. 4467

11004 B

status **PLANNING**

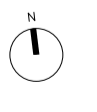

ORIGINAL SHEET SIZE 841 x 594mm